

SCALE

SCALE EXPO & SUMMIT
LONDON | 22 - 23 APRIL 2026

EVENT GUIDE

Sponsored by



**CORPORATE
TRAVELLER™**



scale-london.com



[/scale-london](https://www.linkedin.com/company/scale-london)



[/scale_london_uk](https://www.instagram.com/scale_london_uk)



9:30 SCALE EXPO Opens - Check-in and Networking

10:25 Welcome Address from Conference Chairs **Vasily Alekseenko & Fraya Brinkman**, Rare Founders

10:30 **Women Who Scale: Brand Building for Growth** - Chaired by **Clare Wimalasundera** (Senior Consultant, Visible PR). Featuring **Vivien Wong** (Little Moons), **Juliette Otterburn-Hall** (Value Squared), **Lucy Kane** (TLC Creative Agency) and **Poppy Allan-Spoto** (Adsmart from Sky)

11:05 **The Motivation Myth: What Leaders Get Wrong**. In partnership with **HiBob**. Chaired by **Adam Close** (HiBob). Featuring: **Kelly Evans** (Royal College of Emergency Medicine), **Christina Anderson** (Unforgettable Travel Company), **Sarah Kane** (Conexus Group) and **Grace Mole** (Codat)

11:40 **Preparing to Pitch: Practical guidance for founders embarking on Angel & VC Fundraising** Chaired by **Marc Ortmans** (Global Entrepreneurship Network UK). Featuring: **Peter Jones** (Nineteen Group), **Videsha Boeckle** (altitude), **Rosie Coxshaw** (Modern Woman) and **Simon Landi** (EHE Ventures)

12:20 **Capital in the Wild: Exploring alternative finance options**, in partnership with **Innovate UK**. Chaired by **Scott O'Brien** (Innovate UK). Featuring **Ashleigh Gardner** (Tramlines), **Anthony Lindsay** (Redbridge Chamber of Commerce), **Maahika Singh** (Empower Sounds Media) and **Mia Patel** (Moola)

13:00 **Networking & Lunch**

Women Who Scale presents: Lead with Curiosity
Networking & lunch at the **SCALE Tables**, led by **Lydia Charilaou**

14:00 **Fail Smarter: Turning Setbacks into Breakthroughs**
CEO stories with **Dougal Shaw** and guests **John Stapleton**, **Gurinder Dhillon** and **Steph Hind**

14:40 **Live Pitch Competition - Female Founders**, supported by **Angel Investment Network**
Head Judge: **Liz Barclay**, with judges **Xavier Ballester** (Angel Investors Network), **Ayesha Ofori** (Propelle), **Andrew B Morris** (SCALE Ventures) and **Jamal Hadjkura** (Foundervine)

16:00 **Women Who Scale presents: Healthy Hustle** - Building and growing a business without burnout
Featuring: **Liz Sergeant** (Well Nourished, FLAIR), **Bonnie Smith** (Corporate Traveller), **Chloe Franses** (Hello Franses) and **Alexa Fernandez** (Chili Maven)

17:00 **Day one closes** - See you tomorrow!



9:30 SCALE EXPO Opens - Check-in and Networking

10:25 Welcome Address from Conference Chair, **Mike Millar**, Co-founder, Smp|Co

10:30 Women Who Scale presents: Founders Fireside Chat
Jordan Brompton, co-founder of MyEnergi, talks to Ideas Community founder **Frankie James**

11:05 Leveraging AI on your scaleup journey, sponsored by **Smile IT Solutions**
Chaired by **Ed Soltani** (Smile IT Solutions). Featuring: **Bukky M. Babjide** (Female Techpreneur), **Dominic Kos** (Cleverfox AI), **Ash Chawla** (Duke of Design) and **Asieh Tabaghdehi** (Brunel University)

11:45 The Chairman's Chat
SCALE Chairman **Andrew B Morris** interviews **Nick Butter**, founder of Run Weekends

12:20 Entrepreneurship Across Generations: What fuels founders at different ages and stages?
Chaired by **Tracey Rob Perera** (Innovate UK Scaleup Director and Fractional CFO). Featuring: **Honor & Cat Black** (Maiden Cricket), **Alla Ouvarova** (Two Chicks), **Nico Cossu** (PuffPizza®) and **Mike Anderson** (Dottt, Yeti AI)

13:00 Networking & Lunch

14:00 New Work Order: Building Personal and Financial Resilience for a Flexible Economy
Sponsored by **Now:Pensions**. Featuring: **Alistair Welham**, **Rishal Singh** and **Samantha Gould**

14:40 Live Pitch Competition - Underrepresented founders, supported by **Angel Investment Network**
Head Judge: **Dwain Reid**, with judges **Sapna Shah** (Sie Ventures), **Ryan Panchoo** (Borough 22), **Warren Johnson** (W Communications), and **Reshma Sheikh** (MSDUK)

16:00 Networking - Supported by **SCALE Connectors**

16:30 Day two closes
Register now for SCALE Manchester on 25 November 2026

EXPO Chairs

Vasily Alekseenko

Founder, **Rare Founders**

Vasily is the founder of Rare Founders, one of the largest startup communities in the UK, with over 24,000 founders and investors in the network. He built it from scratch into a go-to platform for early-stage startups looking for capital, connections, and visibility through high-energy events and curated introductions.

He is now building SoPhy, a relationship intelligence tool based on 15 years of research in Social Physics from MIT and Stanford. The product focuses on mapping real business relationships, not vanity connections, and aims to change how people build, manage, and benefit from their networks.

Fraya Brinkman

Partnership & Events Manager, **Rare Founders**

Fraya Brinkman is Partnerships & Events Manager at Rare Founders, one of the UK's fastest-growing startup communities, with over 24,000 founders and investors engaged through its events.

She joined Rare Founders as her entry point into the startup world and quickly found a passion for building the ecosystem from the inside. Today, she leads on partnerships and experience design, creating high-energy events and curated environments where founders and investors can connect in a way that actually leads to opportunity.

Mike Millar

Partner & Head of Brand Strategy, **SmplCo**

Michael is an entrepreneur and investor who helps innovators craft brand strategies that grab attention and build trust in their products & services.

A former journalist (BBC, Reuters, etc.) and political lobbyist, Michael is also co-founder of the multi-award winning product design consultancy SmplCo, which has helped more than 125 entrepreneurs conceive, design and develop their digital products, raise millions in investment, and land innumerable customers.



DAY 1 ≡ 22 APRIL

DAY 2 ≡ 23 APRIL

10:20	Stevens Hewlett & Perkins	Protecting Your Intellectual Property: A Practical Guide to Patents, Trade Marks and Designs for Your Business
-------	---------------------------------	--

10:20	Stevens Hewlett & Perkins	Protecting Your Intellectual Property: A Practical Guide to Patents, Trade Marks and Designs for Your Business
-------	---------------------------------	--

11:20	CORPORATE TRAVELLER	What High Growth SMEs Get Right About Travel
-------	---------------------	--

11:20	HELP TO GROW	Why a clear mission, vision and values is critical for growth
-------	--------------	---

12:20	BSL	The HR burden stealing your growth!
-------	-----	-------------------------------------

12:20	CORPORATE TRAVELLER	What High Growth SMEs Get Right About Travel
-------	---------------------	--

13:20	REED.AI	Introducing Reed.ai: Your AI recruitment agent
-------	---------	--

13:20	BSL	The HR burden stealing your growth!
-------	-----	-------------------------------------

14:20	NORTHSTAR CONSULTING	De-Risking International Expansion in 2026
-------	----------------------	--

14:20	ADSMART FROM SKY	How Scale Ups are using targeted TV to supercharge their growth
-------	------------------	---

15:20	ADSMART FROM SKY	How SMEs are using TV to scale
-------	------------------	--------------------------------

SCALE

22 April - 23 April 2026
London

SCALE is backing diverse founders to shape the scaleup success stories of the future, with live pitch events on both days of our flagship London show.

Ambitious UK founders will take to the stage and pitch live to angel and VC investors.

Female founders and entrepreneurs from underrepresented ethnic communities will leave the stage at SCALE EXPO with clearer next steps, stronger networks and the confidence to take their businesses further.

Alongside the opportunity to connect with investors, two winners will walk away with a package of scaleup support from SCALE Ventures and its partners, including:

Strategic coaching sessions worth £3,000 provided by SCALE Ventures

2 hour organisational resilience workshop, provided by Mike Sutliff, Resilience Expert

1 year of free financial advice and on-demand support for personal and business financial planning, provided by BSG Financial

1 year of free membership to EGYM Hussle

2 months of Global Pro Access to the Angel Investment Network (AIN) platform worth £558

A 30-minute 1-on-1 pitch review session with Angel Investment Network brokerage experts

A dedicated shout-out in the AIN newsletter or LinkedIn page



We've partnered with SmplCo to provide a free Pitch Prep Pack for founders. It's filled with practical activities that represent the distilled wisdom of dozens of successful pitches!



The Pitch Prep
Guide pack

SCALE × SmplCo

SCALE EXPO & SUMMIT
LONDON | 22 - 23 APRIL 2026

Pitch Judges



Liz Barclay

Co-Founder,
Business111.com

Liz Barclay is the co-founder of Business111.com which allows users to navigate to the support they need for their stage in business. Liz is Small Business and Entrepreneurship Special Advisor with the Institute of Directors, and works with several other organisations as a small and micro business champion.

Liz was the Small Business Commissioner for the UK until June 2025. She is also known for her business and communications coaching, broadcasting and journalism.



Dwain Reid

Growth Coach,
dwainreid.com

Dwain Reid grew his childcare business into the largest provider in Lewisham before dedicating his career to empowering underrepresented founders. A business growth coach and former government adviser, Dwain has supported over 10,000 entrepreneurs in launching and scaling their ventures.

Dwain leads on Entrepreneurial Engagement and Early Stage Investment at Forbes Family Group, where he runs the Cap Table Pitch Programme, helping over 300 founders access investment training, networks, and more than £165,000 in funding. Over 60 percent of funded ventures are Black-led.



SPEED NETWORKING

in partnership with



Innovate
UK

Business
Connect

Building a successful business isn't just about what you know - it's about who you know, who knows you, and what you can do together.

At SCALE EXPO & SUMMIT, Speed Networking is designed to help you make meaningful new connections - quickly, efficiently, and at scale.

Running across both days of the event, you'll have multiple opportunities to step in, take part, and meet dozens of ambitious founders, operators, and ecosystem partners who are all there for the same reason: **to grow.**



Why networking matters for entrepreneurs

The right conversation can unlock:

- Your next customer
- A strategic partnership
- A key hire or advisor
- Investment opportunities
- Or simply a fresh perspective that changes how you think

How it works

- Sessions run on the hour, every hour from 11:00 until 16:00 on Day One and between 11:00 and 15:00 on Day Two
- No need to book - first come, first served
- Come prepared with a short intro and what you are looking for



Speed Networking at **#SCALELondon2026** is hosted in partnership with Innovate UK Business Connect



CITY_{AM}

**WHAT'S BLACK
AND WHITE AND
READ ALL OVER?**

OUR APP!

NOW WITH OVER 360,000
USERS, AND COUNTING.
DOWNLOAD YOUR
FREE APP TODAY



CITYAM.COM



PARTNERING WITH
 **Investec**

SCALE SUMMIT

Programme and timings correct at time of print

DAY 1

Wednesday 22 April 2026

09:30 - 17:00



9:30 **SCALE SUMMIT Opens** - Check-in and Networking

10:25 **Welcome Address** from **Irene Graham OBE**, CEO, **ScaleUp Institute**

10:30 **Keynote: Growth, Myths and Mindset Shifts**
Sam Smith, former CEO of **finnCap Group PLC** and co-founder of **The SuperScalers**

11:10 **Investor Panel chaired by Christiana Stewart-Lockhart** (Director General, EISA)
Featuring **Phoebe Kitchen** (Molten VC), **Olly Norman** (Love Ventures) and EISA members

11:45 **Women Who Scale presents: Capital Culture - Creating the conditions for more women to build, scale and invest**
Chaired by **Irene Graham OBE**, **ScaleUp Institute**. Featuring: **Sam Smith** (The SuperScalers), **Louise Doyle** (Needi), **Albert Azis-Clauson** (Tramlines) & **Andrea Sommer** (Womankind Ventures)

12:25 **Women Who Scale presents: Founders' Fireside chat**
Louise Hill, founder of **GoHenry**, talks to **Ayesha Ofori**, founder of **Propelle**

Lunch & Networking

13:00 **Women Who Scale presents:**
Lead with Curiosity - Value-Based Networking
Lunch & networking led by **Lydia Charilaou**

Meet The Investor - Speed Networking in partnership with EIS Association

Introductions and investment opportunities:
your gateway to EIS-backed growth

14:10 **SCALE Tables** - Roundtable sessions exclusive to SCALE SUMMIT pass holders

15:45 **Next-Level Leadership: Building Empowered Teams** How to work less, lead more & scale faster.
Chaired by **Barry McNeill** (Work Extraordinary), featuring **Abby Robbins** (Yellow Bricks Talent Search), **Jonathan McElhatton** (Black Piano) and **Kate Davis** (Meraki People)

16:25 **Scaleup Economics** - Interactive Q&A, chaired by **Simon Hunt** (City AM). Featuring: **Michael Pattinson** (Protospace), **Sam Cooper-Gray** (The Gender Index) & **Asieh Tabaghdehi** (Economist)

17:00 **Day one closes** - See you tomorrow!

SCALE SUMMIT

Programme and timings correct at time of print

DAY 2

Thursday 23 April 2026

09:30 - 16:30



9:30 **SCALE SUMMIT Opens** - Check-in and Networking

10:45 **Welcome Address** from the **Conference Chair**
Christiana Stewart-Lockhart, Director General, **Enterprise Investment Scheme Association**

10:50 **Marcus Stuttgart**, Head of UK Primary Markets & AIM at the **London Stock Exchange Group** (LSEG) will address the SCALE SUMMIT

11:00 **Scaleup Champions: Capital & Collaboration**
How joined-up investors & smarter policy can grow UK innovation globally, without forcing scaleups offshore. Chaired by **Rupert Hargreaves** (City AM). Featuring: **Marcus Stuttgart** (LSEG), **Lewis D'Ambra** (Space Forge), **Grace Almendras Castillo** (Giffitd AI) and **Michael Smith** (Sagittal AI)

11:35 **Women Who Scale presents: Buy Women Built, Founders' Fireside Chat**
Sahar Hashemi, founder of Buy Women Built, chats to **Pippa Murray**, founder of Pip & Nut

12:10 **The Long Game: Funding Routes and paths to Exit** in partnership with **UK Private Capital**
Chaired by **Karim Palant**, UK Private Capital. With: **Joan Mill** (Private Equity Advisor), **Allison Stuckless** (Vericor Capital), **Howard Davies** (Salcombe Gin) and **Will Fraser-Allen** (Albion Capital Group)

12:45 **The Chairman's Chat: Sir Richard Harpin**. The founder of **HomeServe** and owner of **Business Leader**, will be interviewed live on stage by **SCALE** Chairman **Andrew B Morris**

13:15 **Networking & Lunch**

14:00 **SCALE Tables**
Roundtable sessions exclusive to SCALE SUMMIT pass holders

Founder-investor introductions with UK Private Capital
For founders and investors and founders operating in, or supporting, high-growth and innovation-led sectors

15:25 **Founders' Fireside chat**
Tessa Clarke, co-founder of **Olio**, talks to **Hamish Shepherd**, founder of **HelloFresh & Bridebook**

16:00 **Networking**

16:30 **Day two closes** - Register now for SCALE Manchester on 25 November!

SCALE SUMMIT

Programme and timings correct at time of print

SCALE Tables

DAY 1: Wednesday 22 April 2026

SESSION 1 14:10 - 14:50

SESSION 2 14:50 - 15:30

EISA

How **EIS & SEIS schemes** can support your aims as a founder or investor

EISA

How **EIS & SEIS schemes** can support your aims as a founder or investor

techUK

Accelerating Innovation

How technology can prepare & empowering the UK for the future

The Gender Index

Women are good business

The economics of backing female founders

Akaina Talent

The Talent Advantage

How to stand out to top talent

Scribe

Raising from Angel Investors: 101

For seed-stage founders

Action & Achieve

Founders Thinking Room - extended roundtable session

A safe space - for founders only - to share real scaling challenges and leave with solutions. Led by **Tracey Rob Perera**, an Innovate UK Scaleup Director and Fractional CFO

SmplCo

Attention is the new gold

(PRE-SEED) Tell your story so investors, partners, and customers sit up and listen

SmplCo

Attention is the new gold

(SEED-STAGE) Tell your story so investors, partners, and customers sit up and listen

Work Extra-ordinary

Breakthrough Growth

Building a team that scales with you

BSL

More people, more problems?

Discover what the real impact HR is having on your business

Tembo

Big results. Strong partnerships.

Content that connects, and campaigns that convert

Tembo

Big results. Strong partnerships.

Content that connects, and campaigns that convert

Tickl

AI Stack for Scaleups

What to buy, build, or ignore in 2026

Black Piano

Building remote teams

How to hire affordable offshore talent without compromising on quality

SCALE SUMMIT

Programme and timings correct at time of print

SCALE Tables

DAY 2: Thursday 23 April 2026

SESSION 1 ≡ 14:10 - 14:50

SESSION 2 ≡ 14:50 - 15:30

**Chris
Holdsworth**

The right metrics for the right question

How to match metrics to the decisions that drive scale

**Chris
Holdsworth**

The right metrics for the right question

How to match metrics to the decisions that drive scale

**UK
Private
Capital**

Closing the UK scaleup capital gap

What is needed to ensure UK companies can access the capital required to scale globally while remaining headquartered in the UK

**UK
Private
Capital**

Venture capital and the UK Industrial Strategy

How venture investment can support growth in priority sectors such as AI, deep tech, life sciences and defence

**Mike
Sutliff**

Building the Resilient Scaleup: Turning disruption into competitive advantage

The case for making organisational resilience a strategic priority from the outset

**Mike
Sutliff**

Building the Resilient Scaleup: Turning disruption into competitive advantage

The case for making organisational resilience a strategic priority from the outset

**Akaina
Talent**

The Talent Advantage

Interview better... Hire smarter

Scribe

Raising from Angel Investors: 101

For seed-stage founders

Reed.ai

The Changing World of Work

How is AI impacting the way you hire and organise teams?"

Giffid

The Decision Intelligence to Unlock Modern SMEs in the UK's Real Economy

GEN UK

Should I ask for more?

Intralink

Build global, exit bigger

Your guide to doing business in Asia

Tembo

Big results. Strong partnerships.

Content that connects, and campaigns that convert

SUMMIT **Chairs**



Irene Graham
OBE

CEO,
ScaleUp Institute

She is a former senior banker at Standard Chartered where she held both European and global managing director roles. She set up, ran and scaled several of the bank's key client and product businesses across its corporate and institutional bank and led several global M&A activities.

During that time, at the height of the financial crisis, Irene was seconded to work across the banking industry where she led the Business Finance Taskforce and Better Business Finance which was responsible for, amongst other initiatives, the founding of the Business Growth Fund, SME Finance Monitor, and leading on developments in Open Banking, and the Small Business Act.

She is a Visiting Professor of Entrepreneurship at Strathclyde University and holds a variety of NED and advisory roles across the creative, business and finance communities.



Christiana
Stewart-Lockhart

Director General,
Enterprise Investment Scheme Association

Christiana is Director General of the EIS Association (EISA), the trade body for the Enterprise Investment Scheme (EIS) and the Seed EIS ecosystem.

EISA has more than 400 members including entrepreneurs, advisers and investors using the schemes.

Christiana previously spent more than a decade working in Westminster and holds a BA in Politics from the University of York. She was included on the 2025 Women in Trade Associations powerlist, is a member of TISA's Financial Education Council, and sits on the Advisory Board for the APPG for Entrepreneurship.



SCALE SESSIONS

Our year-round events are **focused forums designed for ambitious entrepreneurs** looking to unlock the next stage of growth.

Across intimate roundtables, hands-on workshops, and curated dinners, we dive into challenges and opportunities facing scaleup leaders today.

Built around three core pillars — access to capital, access to talent, and access to markets — SCALE Sessions offer sharp insight, peer-led learning, and meaningful connections that go far beyond the show floor of our larger events.

SCALE Sessions typically take place after work (6-9pm) at the SCALE Hub, near Oxford Street, W1, or at our partner venues in London and Manchester.

Don't miss our next SCALE Session on 20 May 6-9pm

Fail Smarter with Dougal Shaw

The most successful entrepreneurs don't just deal with failure - they harness it for scaling their business.

"Learn how to channel failure as a positive force"



REGISTER

scale-london.com

Lead or support a SCALE Session at the SCALE Hub, at your office, or your chosen venue.

- Host a talk, roundtable or workshop
- Get exclusive use of the SCALE Hub with access to meeting rooms and co-working space
- Invitations sent to the SCALE database and opportunities to collect data of attendees
- SCALE provides staff to host and serve refreshments
- We'll manage the guest list, tickets or invitations, and offer a SCALE Director to MC your event
- A write-up of your SCALE Session will be published on SCALE website post-event

Enquiries: William.Fowler@inflection-point.co.uk



Be in the room where it happens

Upcoming SCALE Sessions

- Wednesday 17 June
- Wednesday 8 July
- Wednesday 16 September
- Wednesday 14 October



register now: scale-london.com



[/scale-london](https://www.linkedin.com/company/scale-london)



[/scale_london_uk](https://www.instagram.com/scale_london_uk)

SCALE SUMMIT

MANCHESTER | 25 NOV 2026

SCALE
Summit cuts
through the
interference

**The North of
England has never
lacked ambitious
founders.
It's a startup
hotspot burning
with ambition.**



Many founders in the region are driven by the same desire to win. To go further. To be the one that breaks through.

Continue the conversation in Manchester and engage with over 300 founders based in and around the north west.

Earlybird tickets
from £95

REGISTER FOR SCALE MANCHESTER



WOMEN ho SCALE

Supercharging the visibility,
investment, and impact of
women-built businesses

Women Who Scale brings together the UK's most influential founders, investors, allies and ecosystem leaders to champion the next generation of women building and scaling businesses with high-growth potential.

Women Who Scale takes a practical, solutions-focused approach to improving outcomes for female founders. It aims to close the gender investment gap by giving female founders and women-led businesses the stage, connections, and support they need to grow, turning their ambition into scaleup success stories and economic wealth.

"We need to go beyond awareness towards meaningful action, to unlock greater participation and investment outcomes for women.

We're creating clear pathways for women entrepreneurs to access the capital they need by plugging into a community of investors, advisors and allies all willing them to succeed."

Amy Knight, co-founder of Women Who Scale



Female Founders at #SCALELondon2026



Louise Doyle,
Needi



Louise Hill,
GoHenry



Irene Graham OBE,
Scaleup Institute



Pip Murray,
Pip & Nut



Ayesha Ofori,
Propelle



Sam Smith,
The SuperScalers



Andrea Sommers,
Hive Founders and
Womankind Ventures



Vivien Wong,
Little Moons



register now: scale-london.com



[/scale-london](https://scale-london)



[/scale_london_uk](https://scale_london_uk)

FLOOR PLAN

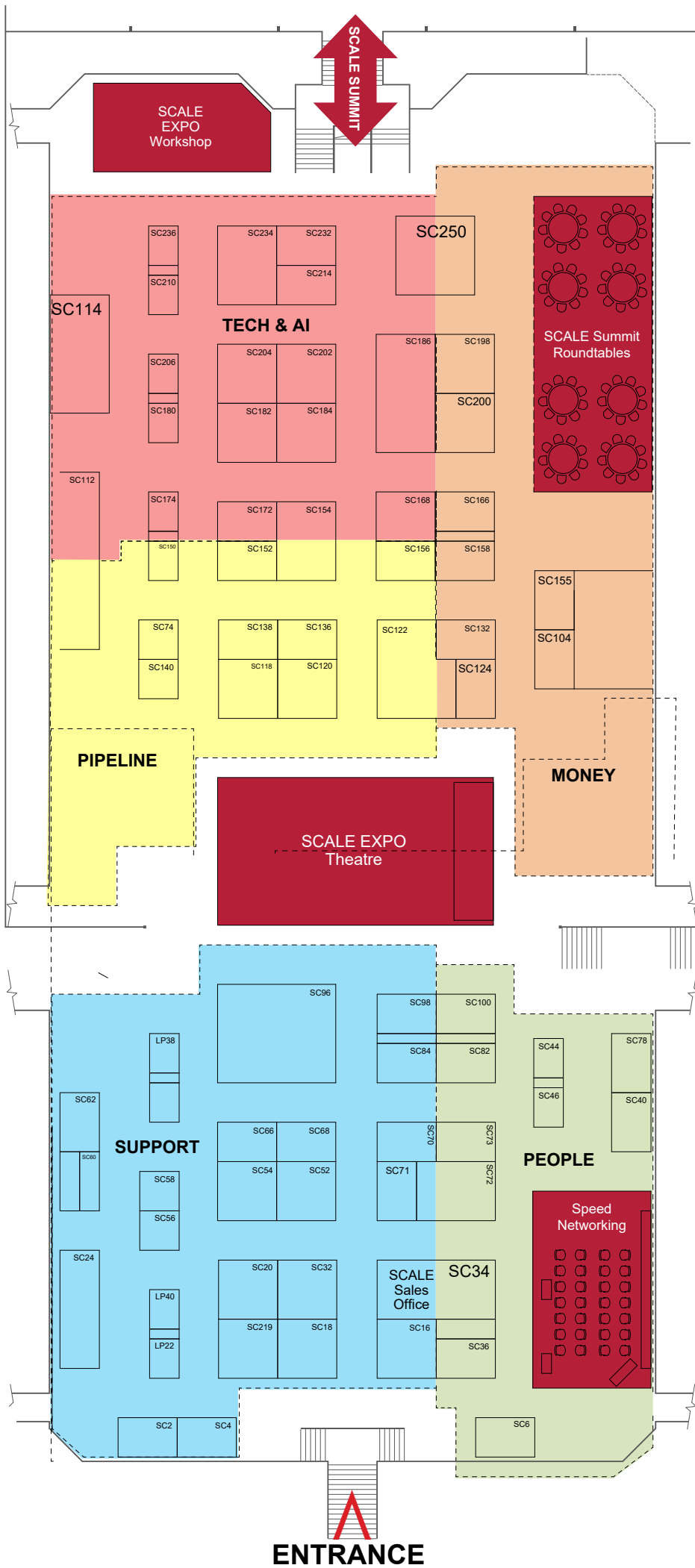

EXHIBITOR DIRECTORY

AccrueTek	SC206	HIVE	SC155
Acumum - Legal & Advisory	LP38	Ideas Fest	SC74
ARCH	SC174	Innovate UK Business Connect	SC82
BBX	SC204	Iwoca	SC200
Bigin	SC120	Killik & Co	SC84
Boardroom Advisors	SC40	LegalVision	SC32
bOnline	SC68	London Chamber of Commerce and Industry	SC4
Boom Training	SC236	Lucidity IP	SC210
BrightHR	SC46	Mercer, a Marsh Business	SC250
BSL	SC100	MSDUK	SC2
Cleverfox AI	SC202	Northstar Consulting UK	SC64
Community Massage Project	SC234	OREE AI	SC52
Corporate Traveller	SC96	Pair Software	SC60
dealOS	SC156	Popcorn CRM	SC140
DECTA	SC166	Professionals UK	SC219
Doshi Outsourcing	SC73	Quik-AI	SC214
DPD	SC24	Reed.ai	SC72
EGYM Hussle	SC44	SCALE Sales Office	SC34
EliteBusiness	SC122	SCCU Business	SC70
Endeavour London	SC136	SH&P	SC20
Eureka Solutions	SC150	Shakers	SC180
EveryCatch	SC154	Smile IT Solutions	SC186
Factorial	SC18	Sompo	SC158
Faith in Finance	SC132	Sound Financial	SC198
Female Techpreneur	SC232	spawn.london	SC184
Fulcrum Solutions	LP22	State Bank of India	SC124
Funky Dory	SC71	Super Benji	SC152
Geecon Global	SC114	Switching Group	SC66
Go Get Organised	SC54	The 196 Foundation	SC78
Grant Thornton	SC98	THE BUSINESS GROWTH NETWORK	SC62
Heartsong Live	SC172	The Cyber Resilience Centre for London	SC182
Hello Fresh	SC104	This is Reel	LP40
Help to Grow - Management	SC56	TLC Creative Solutions Agency	SC138
HiBob	SC16	Visible PR	SC112
HireHarbour	SC6	Work Extraordinary	SC36



Are you scaling... or scrambling?

Growth is complex.
Travel shouldn't be.

Visit us at **Stand SC96.**



Scale globally, travel seamlessly.

 **CORPORATE TRAVELLER™**